

PROGRAM

2013 CASQA 9TH ANNUAL CONFERENCE

SEPTEMBER 9–11, 2013 • SQUAW VALLEY • LAKE TAHOE, CALIFORNIA

WWW.CASQA.ORG

TAKING
STORMWATER
QUALITY
MANAGEMENT
TO NEW HEIGHTS



*Scan with your
smartphone to
view the latest
conference agenda
and abstracts.*





Shaping the Future

Delivering excellence together



Follow Us



AMEC is a leading supplier of consultancy, engineering and project management services to our customers in the world's oil and gas, mining, clean energy, environment and infrastructure markets.

Visit www.amec.com/water for more information.

amec.com

2013 CASQA CONFERENCE

For its 9th annual conference, the California Stormwater Quality Association (CASQA) is pleased to be on the California side of Lake Tahoe for the first time for a special September 9–11, 2013 event. The conference is being held in beautiful Squaw Valley, Lake Tahoe. One of the clearest lakes of its size in the world, Lake Tahoe's clarity has been challenged by accelerated inputs of nutrients and sediment from development and other human impacts. The Lake Tahoe Basin has been at the forefront of scientific studies and technical and policy planning initiatives to protect the Lake by minimizing human disturbance and reducing or eliminating the addition of pollutants. The experiences and lessons learned at Lake Tahoe have a profound influence on our knowledge of stormwater management.

The CASQA Conference is the key annual training opportunity for stormwater professionals responding to municipal, industrial, and construction NPDES stormwater permit requirements and over 500 will attend this year's event.

CASQA is the largest non-profit, professional association focused on stormwater quality issues. For 24 years CASQA has assisted municipalities, special districts, businesses, the State of California, and the United States Environmental Protection Agency in developing and implementing effective stormwater quality management programs.



Incline Village at Lake Tahoe

Photo © Elswaro | Dreamstime.com

ABOUT CASQA

CASQA is a non-profit professional member association dedicated to the advancement of stormwater quality management through collaboration, education and outreach, implementation guidance, regulatory review, and scientific assessment.

JOIN CASQA

Regular or affiliate membership in CASQA is open to organizations and individuals in the stormwater field, whether holders of NPDES permits or not. If you are not currently a member, by joining now, you can receive substantial reductions on upcoming conferences and webcasts, as well as receiving all the other benefits of membership (newsletters,

downloadable products, quarterly meetings, etc.). CASQA membership provides substantial benefits even if you are based outside California. It's the right time to be a member of the premier professional association dedicated to the advancement of stormwater quality management, science, and regulation. Join now at www.casqa.org

Monday, September 9, 2013

IN-DEPTH WORKSHOPS

10 half-day workshops and one all-day field trip workshop on Monday, September 9 will provide in-depth training. All half-day workshops will also be available for viewing by webcast with a registration fee.

MORNING WORKSHOPS

- ◆ **WORKSHOP 1**
Low Impact Development: Bioretention Design
- ◆ **WORKSHOP 2**
Code Enforcement / Inspections / Property Access
- ◆ **WORKSHOP 3**
MS4 Program Monitoring: New Permit Requirements and Innovative Monitoring and Assessment Approaches
- ◆ **WORKSHOP 4**
Hydromodification Control / Management: State of the Practice
- ◆ **WORKSHOP 5**
Building an Outreach Program: the Art, the Science and Community-Based Social Marketing

AFTERNOON WORKSHOPS

- ◆ **WORKSHOP 6**
What Every Stormwater Program Manager “Shall” Know: Guidance from Experienced Phase I and Phase II MS4 Managers
- ◆ **WORKSHOP 7**
Receiving Water Limitations and Legal Basis for Regulating Hydromodification and Flow in TMDLs
- ◆ **WORKSHOP 8**
MS4 Program Monitoring: New Permit Requirements, Stream Health Assessment and Monitoring Data Interpretation
(continued from morning)
- ◆ **WORKSHOP 9**
Hydromodification Control/Management: State of the Practice (continued from morning)
- ◆ **WORKSHOP 10**
Stormwater: A Key Resource in Integrated Water Management



FIELD TRIP

- ◆ **WORKSHOP 11**
Erosion Control and Stormwater Treatment Field Trip (*this workshop is all day, leaving at 8:30 a.m. and returning at 4:30 p.m.*)
Advance registration has reached capacity and is closed.



**DAVID
ANTONUCCI**

TO MAKE KEYNOTE ADDRESS

Tuesday, September 10

8:30 a.m. – 9:40 a.m., the Pavilion

CASQA is very pleased to present David Antonucci as the conference keynote. David is a civil engineer by training with a career as chief of regulation and enforcement for a water quality control board and general manager and chief engineer of a multifunction special district in the Lake Tahoe area. He is currently a freelance writer, professional speaker, and environmental consultant based on the west shore of Lake Tahoe.

His presentation to CASQA will be on Mark Twain at Lake Tahoe. In 1861, the man who became Twain hiked to Lake Tahoe to stake a claim for a timber ranch. He spent many blissful days on the lake but carelessly allowed his campfire to escape, creating a spectacular wildfire. He later wrote about his experiences in his 1872 memoir, *Roughing It*. Twain described Lake Tahoe as the “fairest picture the whole earth affords.”



Photos: courtesy of David C. Antonucci (left); by Terrie Medeiros (right)

Tuesday and Wednesday September 10 – 11, 2013

TECHNICAL PROGRAM

Following a day of workshops, a keynote address, special forums, and concurrent session presentations will provide two additional packed days of stormwater information. Many of the leading stormwater practitioners from California and across the nation are participating and making presentations. Concurrent sessions will follow twelve conference thematic tracks (see pages 6–13 for detailed agendas):

1. BEHAVIOR CHANGE This track will focus on the latest challenges and solutions to changing public and business behavior through public education, training, inspections, and enforcement.

2. CONSTRUCTION PERMIT This track will focus on lessons learned from the field while implementing the California Construction General Permit including compliance strategies, common problems, sampling, bioassessment monitoring, responding to exceedances of numeric action levels, and using active treatment systems.

3. EFFECTIVENESS ASSESSMENT This track will focus on strategies to assess the effectiveness of stormwater programs including effluent limits, numeric action levels, data collection goals and targets, implemented BMPs, effectiveness of source controls, changes in polluting behaviors, reductions in pollutant loading, improvements in receiving water quality, and funding of MS4 programs.

4. GIS APPLICATIONS, MONITORING, AND SCIENTIFIC ADVANCES This track will focus on unique GIS tools, data collection and evaluation, pollutant source tracking, emerging pollutants, new technologies, new monitoring and assessment tools, stormwater impacts, and economic assessments.

5. INDUSTRIAL PERMIT This track will focus on innovative stormwater compliance strategies/case studies, BMP effectiveness evaluations, LID at industrial sites, MS4 industrial program implementation, monitoring strategies/techniques, and practical strategies/solutions to comply with a more stringent California Industrial General Permit expected in 2013, including proposed numeric action levels.

6. LAKE TAHOE This track will focus on programs in the Lake Tahoe Basin including water quality research and science, the recently adopted TMDL, Basin specific NPDES municipal and construction permits and state and local stormwater programs.

7. REGIONAL/INTEGRATED APPROACHES TO STORMWATER COMPLIANCE This track will focus on stormwater compliance through regional/integrated collaboration with flood management, drinking water supply, and wastewater treatment agencies and will include strategies and case studies related to watershed/regional management, integrated water management, and climate change adaptation.

8. REGULATIONS, PERMITS, AND POLICIES This track will focus on the latest developments in federal and state stormwater regulations, permits,

policies, and funding priorities including effluent limitations, receiving water limitations, maximum extent practicable, toxicity policy, Areas of Special Biological Significance, TMDLs/303(d) listing, basin planning issues, and federal NPDES rulemaking.

9. STORMWATER PROGRAM MANAGEMENT This track will focus on innovative ideas and lessons learned from MS4, industrial, and construction stormwater programs regarding implementation strategies, enforcing compliance, internal and external communication with stakeholders, building relationships with regulators, reviewing and implementing stormwater plans, management tools, and auditing and assessment.

10. STORMWATER TREATMENT This track will focus on site-specific approaches, alternative methods, case studies and BMP designs for LID, green infrastructure, green streets, hydromodification, and stormwater harvesting.

11. TMDLS AND POLLUTANT SPECIFIC COMPLIANCE This track will focus on the development, planning, implementation and assessment of TMDL compliance programs including regulations and policies related to TMDL implementation in MS4 permits.

12. TRASH This track will focus on reducing the impact of trash on water bodies including permit requirements, source controls such as public outreach and product bans, full/partial trash capture devices, monitoring and modeling, and assessments of effectiveness.

CONTINUING EDUCATION CREDITS

Continuing Education Credits are available for attendees at the CASQA Conference in the following certifications:

♦ **American Institute of Certified Planners (AICP)** CASQA is an approved AICP Certification Maintenance (CM) Provider. The Annual Conference, including the workshops, has been submitted and is awaiting approval as a multipart event with credits available based on contact hours. AICP certified planners can record credits by logging onto their CM Log and adding the credits from the calendar. Any issues with logging the credits should be sent to AICPCM@planning.org.

♦ **Certified Professional in Erosion and Sediment Control (CPESC); Certified Professional in Storm Water Quality (CPSWQ); Certified Erosion, Sediment and Stormwater Inspector (CESSWI); Certified Inspector of Sediment and Erosion Control (CISEC); and, Certified Municipal Separate Storm Sewer Specialist (CMS4S)** Professional Development Units (PDU) are available for attendance at the CASQA Conference, including the workshops. No sign-in sheets, forms, or certificates are required at the CASQA Conference.

♦ **California Water Environment Association (CWEA)** CWEA contact hours are available for attendance at the CASQA Conference, including the workshops. A CWEA contact hour verification form must be filled out by those requesting CWEA contact hours at the registration table and CASQA will issue a Certificate of Completion.

♦ **State Bar of California** Minimum Continuing Legal Education (MCLE) credits are being requested from the State Bar of California.

2013 CONFERENCE SPONSORS AND EXHIBITORS

CASQA WOULD LIKE TO THANK the following sponsors and exhibitors for supporting the CASQA 2013 Conference.

CASQA invites you to contact the registration desk to reserve your sponsorship and exhibit booth for the 2014 CASQA Conference being held from September 15 to 17.

PLATINUM STORMWATER STEWARD



GOLD STORMWATER STEWARDS



SILVER STORMWATER STEWARDS



MONDAY LUNCH SPONSOR



WEDNESDAY LUNCH SPONSOR



BREAK SPONSOR



INTERNET SPONSOR



MONDAY NIGHT NETWORKING EVENT SPONSORS



- ◆ Carollo Engineers
- ◆ Somach Simmons & Dunn
- ◆ Vali Cooper & Associates, Inc.

- ◆ AEI-CASC Consulting
- ◆ Aquatic Bioassay Consulting
- ◆ Dudek
- ◆ Nautilus Environmental
- ◆ Parsons
- ◆ SCS Engineers
- ◆ Stael Rives

CONFERENCE EXHIBITORS

- ◆ Advanced GeoEnvironmental, Inc.
- ◆ American Peat Technology
- ◆ AquaShield, Inc.
- ◆ Belgard Hardscapes
- ◆ Bio Clean Environmental/Modular Wetlands
- ◆ C.I. Agent StormWater Solutions
- ◆ cbec, inc. eco engineering
- ◆ CBI Systems
- ◆ Clearwater Solutions, Inc.
- ◆ COANDA, Inc.
- ◆ complianceGO
- ◆ CONTECH Engineered Solutions, Inc.
- ◆ CUES
- ◆ dat Mobile Solutions
- ◆ DownStream Services, Inc.
- ◆ EarthGuard by Terra Novo, Inc.
- ◆ Filtrexx International
- ◆ Golder Associates, Inc.
- ◆ Hanna Instruments
- ◆ Inventive Resources, Inc.
- ◆ JBI Water & Wastewater Equipment
- ◆ Jensen Precast
- ◆ KriStar Enterprises, Inc.
- ◆ Neptune Wheel Wash Systems
- ◆ NV5
- ◆ Oldcastle Precast
- ◆ PACE Advanced Water Engineering
- ◆ Reed & Graham, Inc.
- ◆ REM | Revel Environmental Manufacturing, Inc.
- ◆ Rinker Materials Concrete Pipe Division
- ◆ Roscoe Moss Company
- ◆ SCI Consulting Group
- ◆ Shift Business Intelligence, Inc.
- ◆ Sound Earth Strategies, Inc.
- ◆ State Water Resources Control Board
- ◆ StormChamber
- ◆ Storm Water Systems
- ◆ Stormwater USA, LLC
- ◆ SWIMS, Inc. Storm Water Inspection & Maintenance Services
- ◆ Tetra Tech
- ◆ United Storm Water, Inc.
- ◆ Vieux & Associates, Inc.
- ◆ XP Solutions

KriStar & Filtterra

Low Impact Development Stormwater Management Products

Bio-Mod Modular Bioretention System

Filtterra Stormwater Bioretention Systems

CUDO Water Storage System

Filtterra Internal Bypass - Curb w/Pre-Filter

SwaleGard Pre-Filter

Filtterra Internal Bypass - Curb

Mono-Cube Stormwater Detention/Infiltration/Harvesting

Filtterra Internal Bypass - Pipe

SwaleGard Swale Overflow Filter



KriStar Enterprises, Inc.
800-579-8819 | www.kristar.com

Filtterra Bioretention Systems
866-349-3458 | www.filtterra.com

**Visit our
Booth #21
at
CASQA 2013**

CASQA WORKSHOPS AGENDA, MONDAY SEPTEMBER 9, 2013

7:30a – 5:30p		REGISTRATION DESK (FOYER)			
11:45a – 6:00p		EXHIBITS (GRAND SIERRA)			
ALL DAY		WORKSHOP 11 – EROSION CONTROL AND STORMWATER TREATMENT FIELD TRIP (takes place offsite –see details below, advance registration has reached capacity and is closed)			
	WORKSHOP 1 ALPINE A	WORKSHOP 2 GRAND SIERRA C	WORKSHOP 3 ALPINE B	WORKSHOP 4 MONUMENT PEAK A&B	WORKSHOP 5 EMIGRANT PEAK A&B
Workshop	Low Impact Development: Bioretention Design	Code Enforcement / Inspections / Property Access	MS4 Program Monitoring: New Permit Requirements and Innovative Monitoring and Assessment Approaches	Hydromodification Control / Management: State of the Practice	Building An Outreach Program: The Art, the Science and Community-Based Social Marketing
8:30 – 10:00	<p>Welcome, Opening Remarks and Overview <i>Daniel Apt : RBF Consulting</i></p> <hr/> <p>Bioretention Design, Construction and Maintenance: (a) Basic Siting and Design Component <i>Darla Inglis : UC Davis</i> (b) Aggregate, Soil Media, and Mulch <i>Melanie Mills : Cal Poly San Luis Obispo</i> (c) Advancement in Bioretention Media for Targeted Pollutant Removal <i>Ryan Winston : North Carolina State University;</i> <i>Aaron Poresky : Geosyntec Consultants</i></p>	<p>Welcome, Opening Remarks and Overview <i>Andre Monette : Best, Best & Kreiger</i></p> <hr/> <p>Code Enforcement - Expectations of the Regulatory Agencies and Access and Due Process Hurdles to Enforcing Municipal Stormwater Programs <i>Andrew Brady : Richards, Watson & Gershon;</i> <i>Laurie Walsh : San Diego Water Board;</i> <i>Julie Macedo : State Water Board Office of Chief Counsel</i></p>	<p>Welcome, Opening Remarks and Overview <i>Bram Sercu : Ventura County Watershed Protection District</i></p> <hr/> <p>New Permit Requirements - A Multi-Permit Comparison of MS4 Monitoring Requirements <i>Bram Sercu : Ventura County Watershed Protection District;</i> <i>Donna Bodine : Geosyntec Consultants</i></p> <hr/> <p>- Monitoring in LA: Mishaps, Musings, and the Municipal Permit <i>Donna Chen, Jon Ball, Vivian Marquez : City of Los Angeles</i></p> <hr/> <p>- Developing a Multi-Agency Monitoring Program for the Bay Area Municipal Regional Permit <i>Arleen Feng : Alameda County</i></p>	<p>Welcome, Opening Remarks and Overview <i>Nancy Gardiner : Haley & Aldrich</i></p> <hr/> <p>Overview, Evolution of Hydromodification Management to Date, Purpose <i>Dave Renfrew : Weston Solutions;</i> <i>Judd Goodman : Geosyntec Consultants</i></p> <hr/> <p>Element 1: Physical Setting & Applicability <i>Chris Bowles : CBEC;</i> <i>Arne Anselm : Ventura County Watershed Protection District</i></p> <hr/> <p>Element 2: Performance Standard <i>Jill Bicknell : Santa Clara Valley Urban Runoff Pollution Prevention Program</i></p>	<p>Welcome, Opening Remarks and Overview <i>Stephen Groner : SGA</i></p> <hr/> <p>(a) Community-Based Social Marketing (CBSM) – Outreach Campaign Strategies and Getting to Behavior Change (b) Developing Motivators – Gialdini's Six Powers of Persuasion Techniques to Enhance CBSM Strategies <i>Stephen Groner : SGA</i></p>
10:00 – 10:15	BREAK (FOYER)				
10:15 – 11:45	<p>(d) Trees and Plants in Bioretention Areas <i>Melanie Mills : Cal Poly San Luis Obispo</i></p> <hr/> <p>Identifying Retrofit Opportunities in the Urban Environment <i>Kevin Robert Perry : UC Davis</i></p> <hr/> <p>Green Street – Case Studies and Examples <i>Daniel Apt, Anna Lantin : RBF Consulting</i></p> <hr/> <p>Closing Remarks <i>Daniel Apt : RBF</i></p>	<p>System Maintenance - Challenges to Operating and Maintaining Flood Control Channels that are Also Waters of the United States <i>Heather Stroud : City of San Diego;</i> <i>Katharine Wagner : Downey Brand;</i> <i>David Burbenn : Burbenn & Gest</i></p> <hr/> <p>Closing Remarks <i>Andre Monette : Best, Best & Kreiger</i></p>	<p>Model Monitoring - Considerations for Optimal Monitoring Program Design <i>Brock Bernstein : Consultant</i></p> <hr/> <p>- Lessons Learned from a Mature Monitoring Program <i>Chris Crompton : County of Orange</i></p> <hr/> <p>- San Gabriel River Regional Monitoring: A Model Program for the State <i>Nancy Steele : Council for Watershed Health</i></p> <hr/> <p>- Panel Discussion on New Permits and Model Programs <i>All Morning Speakers</i></p>	<p>Element 3: Implementation Methods <i>Lisa Austin : Geosyntec Consultants</i></p> <hr/> <p>Element 4: Sizing / Design Guidance <i>Judd Goodman : Geosyntec Consultants;</i> <i>Doug Beyerlein : Clear Creek Solutions;</i> <i>Andy Collison : ESA-PWA</i></p>	<p>(c) Building a Communications Plan (d) Developing Tactics from Social Media to an Event (e) Evaluating Your Program <i>Nick Laurell, Stephen Groner : SGA</i></p> <hr/> <p>Closing Remarks <i>Stephen Groner : SGA</i></p>
11:45 – 1:30	EXHIBITOR FOCUS (GRAND SIERRA) AND LUNCH (PAVILION)				

WORKSHOP 11

Erosion Control and Stormwater Treatment Field Tour

Monday, September 9, All Day

A guided tour through the Lake Tahoe watershed, visiting sites where erosion control and stormwater treatment measures have been constructed to protect Lake Tahoe, a natural treasure.

Field Tour Leaders:

Jason Drew : Nichols Consulting Engineers;
Jeff Endicott : AEI-CASC Consulting;
Guest Speakers at each site

8:00 a.m. – meet outside the hotel lobby

8:30 a.m. sharp – buses depart

Box lunches will be provided

4:30 p.m. – buses return

CASQA WORKSHOPS AGENDA, MONDAY SEPTEMBER 9, 2013 (cont.)

	WORKSHOP 6 ALPINE A	WORKSHOP 7 GRAND SIERRA C	WORKSHOP 8 ALPINE B	WORKSHOP 9 MONUMENT PEAK A&B	WORKSHOP 10 EMIGRANT PEAK A&B
Workshop	What Every Stormwater Program Manager "Shall" Know	Receiving Water Limitations and Legal Basis for Regulating Hydromodification and Flow in TMDLs	MS4 Program Monitoring: New Permit Requirements, Stream Health Assessment and Monitoring Data Interpretation (Continuation)	Hydromodification Control / Management: State of the Practice (Continuation)	Stormwater: A Key Resource in Integrated Water Management
1:30 – 3:00	<p>Welcome, Opening Remarks and Overview : <i>Daniel Apt : RBF Consulting</i></p> <hr/> <p>Program Optimization and Lessons Learned: (a) Phase II Traditional <i>Cathleen Garnand : Santa Barbara County</i> (b) Phase II Non-Traditional <i>Courtney Trask : UC Santa Cruz</i> (c) Phase I <i>Amanda Carr : City of Irvine</i></p> <hr/> <p>Implementing the Phase II Permit Post-Construction Requirements <i>Dan Cloak : Dan Cloak Environmental Consulting</i></p>	<p>Welcome, Opening Remarks and Overview : <i>Andre Monette : Best, Best & Kreiger</i></p> <hr/> <p>Hydromodification and Flow TMDLs - Basis for Regulating Volume of Discharge and Implications for Proposed EPA Regulations <i>Ryan Baron : County of Orange County Counsel;</i> <i>Mary Lynn Coffee : Nossaman LLP;</i> <i>Nathan Gardiner-Andrews : NACWA</i></p>	<p>Statistical Analysis and Reporting - Ranking Sites for BMP Placement While Accounting for Permit Limits, Natural Background Levels, Number of Samples, and Exceedance Frequency <i>Robert Pitt : University of Alabama</i></p> <hr/> <p>- Using Data to Make Management Decisions/Prioritizations and Monitoring Program Revisions in Lake Tahoe <i>Alan Hayvaert : Desert Research Institute</i></p> <hr/> <p>- MS4 Pollutant Loads in Small Urban Watershed: Approaches to Supplement Monitoring Data <i>Lester McKee : San Francisco Estuary Institute</i></p>	<p>Element 5: Monitoring and Adaptive Management <i>Tom Dalziel : Contra Costa County;</i> <i>Christine Sloan : San Diego County</i></p>	<p>Welcome, Opening Remarks and Overview : <i>Richard Boon : County of Orange</i></p> <hr/> <p>Changing Paradigms in the Way We Manage Our Water Resources <i>Carmel Brown : California Department of Water Resources</i></p> <hr/> <p>State Leadership for Advancing Integrated Water Management: Introducing Water 360 <i>Carmel Brown : California Department of Water Resources</i></p> <hr/> <p>The Federal Push Toward Integrated Water Management <i>Jack Landy or Gail Louis : U.S. EPA Region 9</i></p> <hr/> <p>The Role of the Water Boards and Other State Agencies in Integrated Regional Water Management <i>Steven Moore : Board Member, State Water Board</i></p>
3:00 – 3:30	BREAK AND EXHIBITOR FOCUS (GRAND SIERRA)				
3:30 – 5:00	<p>Innovative Ideas for Funding Your Stormwater Program <i>John Bliss : SCI Consulting Group</i></p> <hr/> <p>Program Effectiveness Assessment <i>Karen Asbby : Larry Walker Associates</i></p> <hr/> <p>Closing Remarks <i>Daniel Apt : RBF Consulting</i></p>	<p>Receiving Water Limitations - Status of State Board Policy on Incorporating Receiving Water Limitations in Municipal Stormwater Permits and National Perspective on Current Requirements <i>Melissa Thorne : Downey Brand;</i> <i>Theresa Dunham : Somach Simmons & Dunn;</i> <i>Shawn Hagerly : Best, Best & Kreiger</i></p> <hr/> <p>Closing Remarks <i>Andre Monette : Best, Best & Kreiger</i></p>	<p>Special Studies - Performing a Successful Microbial Source Tracking Study: The Importance of Site Reconnaissance, Method Selection, and Data Interpretation <i>Jared Ervin : University of California Santa Barbara</i></p> <hr/> <p>- Watershed-Wide MS4 Outfall Dry Weather Bacteria Source Tracking Study <i>Jo Ann Weber : San Diego County;</i> <i>Brandon Steets, Rita Kampalath : Geosyntec Consultants;</i> <i>Donna Ferguson : UC Los Angeles</i></p> <hr/> <p>- Natural Loadings of Fecal Indicator Bacteria, Metals and Nutrients from Southern California Reference Streams: Improving the Scientific Basis for Water Quality Standards <i>Martha Sutula : Southern California Coastal Water Research Project</i></p> <hr/> <p>- Monitor, Model, Confirm, Assess – Bay Area Approaches to Estimating Stormwater Trash Generation and Assessing Progress Towards Load Reduction Goals <i>Chris Sommers : EOA, Inc.</i></p> <hr/> <p>Closing Remarks <i>Bram Sercu : Ventura County Watershed Protection District</i></p>	<p>Project Proponent Perspective: What is Being Built <i>Mark Grey : Southern California BIA</i></p> <hr/> <p>Potential Future Elements of Hydromodification Management <i>Greg Gearhart : State Water Board;</i> <i>Eric Stein : Southern California Coastal Water Research Project</i></p> <hr/> <p>Closing Remarks <i>Nancy Gardiner : Haley & Aldrich</i></p>	<p>Experiences from the Tahoe Sierra Integrated Regional Water Management Group <i>Lynn Nolan : Tahoe Public Utility District</i></p> <hr/> <p>Successes and Lessons Learned from the One Water, One Watershed (OWOW) Program <i>Celeste Cantu : Santa Ana Watershed Project Authority</i></p> <hr/> <p>Innovative Case Studies in Integrated Water Management from Southern California and Seattle <i>Eric Strecker : Geosyntec Consultants</i></p> <hr/> <p>Closing Remarks – Next Steps <i>Richard Boon : County of Orange;</i> <i>Carmel Brown : California Department of Water Resources</i></p>
5:00 – 6:00	EXHIBITOR FOCUS (GRAND SIERRA)				
6:00 – 9:30	MONDAY EVENING SOCIAL EVENT AT HIGH CAMP – EXTRA FEE APPLIES				

CASQA TECHNICAL PROGRAM AGENDA, TUESDAY SEPTEMBER 10, 2013

7:30a – 5:30p					
REGISTRATION DESK (FOYER)					
7:30a – 8:30a					
MODERATOR ORIENTATION (GRAND SIERRA C)					
8:00a – 7:30p					
EXHIBITS (GRAND SIERRA)					
PLENARY SESSION 8:30a – 9:40a					
WELCOME AND OPENING REMARKS – Richard Boon, Chair, CASQA (PAVILION) KEYNOTE ADDRESS – <i>Mark Twain at Lake Tahoe</i> – David Antonucci					
9:40a – 10:00a					
BREAK AND EXHIBITOR FOCUS (GRAND SIERRA)					
	TRACK A ALPINE A	TRACK B ALPINE B	TRACK C GRAND SIERRA C	TRACK D MONUMENT PEAK A&B	TRACK E EMIGRANT PEAK A&B
SESSION 1	STORMWATER TREATMENT	INDUSTRIAL PERMIT General Permit	TMDLs AND PROGRAM SPECIFIC COMPLIANCE Implementation in the Bay Area	STORMWATER PROGRAM MANAGEMENT	REGULATIONS, PERMITS & POLICIES
MODERATOR	Lisa Austin : Geosyntec Consultants	Katherine Wagner : Downey Brand	Jon Konnan : EOA Inc.	Lisa Haney : Orange County Sanitation District	Scott Taylor : RBF Consulting
10:00 – 10:30	Advancing Biofiltration Design to for Pollutant-Specific Effluent Limits and Enhanced System Longevity <i>Aaron Poresky : Geosyntec Consultants</i>	The Draft Industrial General Permit – Regulated and Regulator Perspectives <i>Greg Gearheart : State Water Board</i> <i>Matt Lentz : AMEC</i>	Approaches to Reducing Urban Stormwater Runoff Pollutant Loads and Implementing the San Francisco Bay PCB and Mercury TMDLs <i>Jon Konnan : EOA, Inc.</i>	Getting Ahead of the Wave – City of San Diego Watershed Asset Management Planning <i>Ed Othmer : URS Corporation</i>	Establishing the Basis and Framework for Water Quality Low Impact Development Alternative Compliance Programs <i>Mark Grey : Construction Industry Coalition on Water Quality</i>
10:30 – 11:00	Bioretention for Hydromodification Management and On-Site Retention: Verification of a Model for Predicting Performance <i>Tom Dalziel : Contra Costa Clean Water Program</i>		Efforts to Reduce Mass Loadings of PCBs in the City of Oakland CA <i>Rebecca Tuden : City of Oakland</i>	When Municipal Staff Become Researchers <i>Deborah Mosley, James Hook : City of San Diego</i>	Lessons Learned from Two Years of “Rigorous” Retain On-Site LID Implementation in Orange County <i>Richard Boon : County of Orange</i>
11:00 – 11:30	Stormwater and Vector Control Program Design Elements <i>Marty Scholl : Sacramento - Yolo Mosquito and Vector Control District</i>	Programmatic Challenges to Industrial Stormwater Compliance <i>Matt Hillyard : Integral Consulting, Inc.</i>	Not as Easy as We Make it Look: Designing LID Stormwater Treatment Retrofits in Highly Constrained Urban Settings <i>Lynne Scarpa : City of Richmond</i>	Back to the Future: A Paradigm Shift and Application of the Scientific Method <i>Garrett Williams : E2 ManageTech, Inc</i>	San Diego MS4 Permit Adoption <i>Matthew Rich : AMEC</i>
ALTERNATE	Are Low Impact Development Projects Accumulating Constituents that Represent a Long Term Risk – State of Science on LID <i>Sumer Hasenin : City of San Diego</i>		Using a Stakeholder Driven Process to Develop a TMDL – Driven Restoration at Los Peñasquitos Lagoon <i>Mike Hastings : Los Peñasquitos Lagoon Foundation</i>	El Dorado County Lake Tahoe Municipal NPDES Program Overview – Doing More with Less – Implementer's Perspective <i>Brendan Ferry : El Dorado County</i>	
11:30 – 12:00					
EXHIBITOR FOCUS (GRAND SIERRA)					
12:00 – 1:30					
LUNCH (PAVILION) – CASQA AWARDS PROGRAM					
	TRACK A ALPINE A	TRACK B ALPINE B	TRACK C GRAND SIERRA C	TRACK D MONUMENT PEAK A&B	TRACK E EMIGRANT PEAK A&B
SESSION 2	SCIENTIFIC ADVANCES Partnerships for International Research and Education (PIRE)	INDUSTRIAL PERMIT Implementation	REGIONAL / INTEGRATED APPROACHES TO STORMWATER COMPLIANCE	MONITORING	EFFECTIVENESS ASSESSMENT Stormwater Programs
MODERATOR	Ashmita Sengupta : Southern California Coastal Water Research Project	Matt Lentz : AMEC	Nicole West : LSA Associates, Inc.	David Gillett : Southern California Coastal Water Research Project	Kristina Schneider : AMEC
1:30 – 2:00	Building Tools to Link Stormwater Best Management Practices (BMPs) to Stream Quality: A Joint Australian and U.S. Study <i>Ashmita Sengupta : Southern California Coastal Water Research Project</i> A New Approach for Parameterization of Mass Transfer in the Photocatalytic Natural Treatment Systems <i>Morvarid Azizian : University of California Irvine</i>	Finding the Source of Dissolved Copper in Stormwater Using X-Ray Fluorescence <i>Ryan Janoch : Terraphase Engineering</i>	Rethinking the Flood Control Paradigm: An Integrated Planning Approach for Water Quality, Water Supply, Flood Control, and Neighborhood Revitalization in Austin, Texas <i>Aaron Poresky : Geosyntec Consultants</i>	Site-Specific Indices Improve Bioassessment in Complex Environments: An Introduction to the California Stream Condition Index <i>Raphael Mazon : Southern California Coastal Water Research Project</i>	Meeting the Challenge: the Ventura Stormwater Permit Three Years Later, Accomplishments, Lessons and the Future <i>Gerhardt Hubner : Ventura County Watershed Protection District</i>

CASQA TECHNICAL PROGRAM AGENDA, TUESDAY SEPTEMBER 10, 2013 (cont.)

	TRACK A ALPINE A	TRACK B ALPINE B	TRACK C GRAND SIERRA C	TRACK D MONUMENT PEAK A&B	TRACK E EMIGRANT PEAK A&B
SESSION 2	SCIENTIFIC ADVANCES Partnerships for International Research and Education (PIRE)	INDUSTRIAL PERMIT Implementation	REGIONAL / INTEGRATED APPROACHES TO STORMWATER COMPLIANCE	MONITORING	EFFECTIVENESS ASSESSMENT Stormwater Programs
MODERATOR	Tom Lawrence : Stormwater Consultant	Matt Lentz : AMEC	Nicole West : LSA Associates, Inc.	David Gillett : Southern California Coastal Water Research Project	Kristina Schneider : AMEC
2:00 – 2:30	<p>Detecting Change in the Stormwater Response of Urban Watersheds Using the Instantaneous Unit Hydrograph Method <i>Asal Askarizadeh :</i> <i>Southern California Coastal Water Research Project</i></p> <p>The Resiliency of Integrated Urban Water Systems: An Empirical Study on Transformative Social Change in Consumption Behavior and Implications for Achieving Water-Sensitive Urban Design <i>Kathleen Low :</i> <i>University of California Irvine</i></p>	<p>Stormwater Challenges and Solutions for Intermodal Facilities <i>Ross Dunning :</i> <i>Kennedy / Jenks Consultants</i></p>	<p>Utilizing Innovative Design Solutions to Achieve Stream Channel Restoration and SSO Consent Decree Implementation Objectives for a Large Suburban Wastewater Collection System <i>Lawrence Magura :</i> <i>Black & Veatch Corp</i></p>	<p>Presence and Toxicity of Current-Use Pesticides in Urban Waterways and Implications for Stormwater Managers <i>Armand Ruby :</i> <i>Armand Ruby Consulting</i></p>	<p>Source and Impact Strategies for Stormwater Management Plans <i>Jon Van Rhyne :</i> <i>County of San Diego</i></p>
2:30 – 3:00	<p>Optimized Water Sensitive Urban Design: Trade-offs in Pollutant Removal Efficiency <i>Megan Rippey :</i> <i>University of California Irvine</i></p>	<p>Industrial Dischargers – Think Outside the (Treatment) Box <i>Tim Simpson :</i> <i>AMEC</i></p>	<p>Which Came First? The Watershed Management Plan or the Reasonable Assurance Analysis? <i>Dustin Bambic :</i> <i>Tetra Tech</i></p>	<p>High Resolution Monitoring Data and Applications for Sacramento Stormwater Urban Runoff and Ambient Monitoring <i>Brian Laurenson :</i> <i>Larry Walker Associates</i></p>	<p>Evaluating the Effectiveness of Source Control Measures for Pesticides <i>Vishakha Atre :</i> <i>EOA, Inc.</i></p>
ALTERNATE				<p>Tools of the Trade and Making the Call During the Wet Weather Season <i>Garth Engelhorn :</i> <i>Weston Solutions</i></p>	<p>Technical Guidance for Achieving Volume Reduction of Urban Highway Runoff: A Nationwide Perspective <i>Eric Strecker :</i> <i>Geosyntec Consultants</i></p>
3:00 – 3:30	BREAK AND EXHIBITOR FOCUS (GRAND SIERRA)				
	TRACK A ALPINE A	TRACK B ALPINE B	TRACK C GRAND SIERRA C	TRACK D MONUMENT PEAK A&B	TRACK E EMIGRANT PEAK A&B
SESSION 3	STORMWATER TREATMENT	MONITORING	REGIONAL / INTEGRATED APPROACHES TO STORMWATER COMPLIANCE	STORMWATER PROGRAM MANAGEMENT	BEHAVIOR CHANGE
MODERATOR	Anna Lantin : RBF Consulting	Garth Engelhorn : Weston Solutions, Inc.	Nicole West : LSA Associates, Inc.	Steve Herrera : Herrera Engineering Consultants, Inc.	Mathew Fabry : San Mateo County Water Pollution Prevention Program
3:30 – 4:00	<p>LID Selection and Sizing Tool for Achieving Water Balance in California <i>Maureen Kerner :</i> <i>CSU Sacramento Office of Water Programs</i></p>	<p>The Stream Pollution Trends (SPoT) Monitoring Program: A Preliminary Assessment of Emerging Contamination and Toxicity Trends in California <i>Bryn Phillips :</i> <i>UC Davis</i></p>	<p>Central Valley Drinking Water Policy and Collaborative Science in the Sacramento-San Joaquin Delta <i>Brian Laurenson :</i> <i>Larry Walker Associates</i></p>	<p>Developing User-Friendly Tools for Construction Stormwater Compliance and Management on the Stanford University Campus <i>Julia Nussbaum :</i> <i>Stanford University</i></p>	<p>Lessons from Game Design: Psychology, Strategy, and Structure to Make Outreach More Engaging <i>Stephen Groner :</i> <i>S. Groner Associates</i></p>
4:00 – 4:30	<p>Generalizing Continuous Hydrologic Simulation for Rapid BMP Performance Assessment <i>Marc Leisenring :</i> <i>Geosyntec Consultants</i></p>	<p>A New Paradigm? The Future of Pesticides & Toxicity Monitoring <i>Kelly Moran :</i> <i>TDC Environmental, LLC</i></p>	<p>Specialized Integrated Watershed Runoff Management Planning for Large Planned Development Communities <i>Bruce Phillips :</i> <i>PACE Advanced Water Engineering</i></p>	<p>The Game Changer: How to Create a Cultural Shift to Achieve Breakthrough Results in Your SWPPP Program <i>Kevin Drake :</i> <i>Integrated Environmental Restoration Services</i></p>	<p>Preventing Pollution from Shade Tree Mechanics: Using GIS, CBSP, and Multi-Ethnic Outreach to Change Behavior <i>Cynthia Knowles :</i> <i>San Francisco Department of the Environment</i></p>

CASQA TECHNICAL PROGRAM AGENDA, TUESDAY SEPTEMBER 10, 2013 (cont.)

	TRACK A ALPINE A	TRACK B ALPINE B	TRACK C GRAND SIERRA C	TRACK D MONUMENT PEAK A&B	TRACK E EMIGRANT PEAK A&B
SESSION 3	STORMWATER TREATMENT	MONITORING	REGIONAL / INTEGRATED APPROACHES TO STORMWATER COMPLIANCE	STORMWATER PROGRAM MANAGEMENT	BEHAVIOR CHANGE
MODERATOR	Anna Lantin : RBF Consulting	Garth Engelhorn : Weston Solutions, Inc.	Nicole West : LSA Associates, Inc.	Steve Herrera : Herrera Engineering Consultants, Inc.	Mathew Fabry : San Mateo County Water Pollution Prevention Program
4:30 – 5:00	Development and Application of a Web-Based Post-Construction Stormwater BMP Feasibility Screening Tool <i>Vaikko Allen : Contech Engineered Solutions</i>	Pyrethroid Analysis – What Should We Be Looking For? <i>Ted Von Bilner : AMEC</i>	An Integrated Water Resources and Watershed Management Approach in Southern California through Development of Watershed Action Plans <i>Daniel Apt : RBF Consulting</i>	Building Compliance Bridges <i>Lisa Haney : Orange County Sanitation Districts</i>	The IPM Advocate Program: Changing How Pesticides are Sold in Retail Stores <i>Nita Davidson : Department of Pesticide Regulation</i>
ALTERNATE	Cloud Computing and Stormwater Control: Integrating the “Internet-of-Things,” Green Infrastructure, and Hydromodification Management <i>Jeffrey Bate : Geosyntec Consultants</i>	Causal Assessment as Part of California’s Bio-Objectives: What is It and How Does One Do It? <i>David Gillett : Southern California Coastal Water Research Project</i>		Lessons Learned from Linear Underground / Overhead Projects SWPPP Development and Implementation <i>Tania Curulla : Geosyntec Consultants</i>	
5:00 – 7:00	EXHIBITOR RECEPTION (GRAND SIERRA)				



Creating value by delivering innovative and sustainable solutions for infrastructure and the environment.



TMDL Planning & Implementation • Water Quality Master Planning
 Treatment BMP Design • Source Control BMPs • NPDES MS4 Program Development
 Non-Traditional Permittee Program Development • Construction Site Stormwater Compliance & Training
 Hydromodification Plan Development • Sediment Transport Modeling • BMP Effectiveness Assessment • Engineering & Science

www.rbf.com ■ www.mbakercorp.com ■ 800.479.3808

GOLD STORMWATER STEWARD

CASQA TECHNICAL PROGRAM AGENDA, WEDNESDAY SEPTEMBER 11, 2013

7:00a – 8:30a QSD / QSP CONSTRUCTION FORUM (ALPINE A) – Chaired by Gerald Montgomery : Montgomery & Associates (<i>see p. 13 for details</i>)					
7:00a – 8:30a LID ROUNDTABLE (ALPINE B) – Chaired by Scott Taylor : RBF Consulting and Jennifer Krebs : State Water Board (<i>see p. 13 for details</i>)					
7:30a – 12:00p REGISTRATION DESK (FOYER)					
8:00a – 1:30p EXHIBITS (GRAND SIERRA)					
	TRACK A ALPINE A	TRACK B ALPINE B	TRACK C GRAND SIERRA C	TRACK D MONUMENT PEAK A&B	TRACK E EMIGRANT PEAK A&B
SESSION 4	LAKE TAHOE	TRASH Regulation	TMDLS AND PROGRAM SPECIFIC COMPLIANCE Bacteria	STORMWATER PROGRAM MANAGEMENT Trending Issues	CONSTRUCTION PERMIT
MODERATOR	Jason Drew : Nichols Consulting Engineers	Jim Scanlin : Alameda Countywide Clean Water Program	Amanda Carr : City of Irvine	Tracy Ingebrigsten : City of Laguna Beach	Sandy Mathews : Larry Walker Associates
8:00 – 8:30 EXHIBITOR FOCUS (GRAND SIERRA)					
8:30 – 9:00	Importance of Stormwater Management in the Truckee River Watershed – Lake Tahoe to Pyramid Lake <i>Terry Svetich : City of Reno</i>	California's Trash Reduction Regulations <i>Jonathan Bishop : State Water Board;</i> <i>Dale Bowyer : San Francisco Water Board</i>	Steps Towards Bacteria TMDL Compliance: The Inner Cabrillo Beach Plan for Assessing Eligibility for a Natural Source Exclusion Designation <i>Lisa Kay : Weston Solutions, Inc.</i>	Illicit Discharge Detection & Elimination (IDDE) Through an Effective Dry Weather Outfall Monitoring Approach <i>Mary Anne Skorpanich : County of Orange</i>	Ask the Regulator – Insights and Lessons Learned by Regional Board Staff Inspecting Construction Sites <i>Annalisa Kibara</i> <i>Paul Keiran</i> <i>Rich Muhl</i> <i>Bud Amorfini</i> <i>Alex Alimobamadi</i> <i>Dannas Berchold : State and Regional Water Boards</i>
9:00 – 9:30	Watershed Outfall Inventory and Analysis – County of El Dorado <i>Daniel Kikkert : El Dorado County</i>		Achieving Recreation Use Water Quality Standards in Effluent Dominated Waterbodies <i>Steven Wolosoff : CDM Smith</i>	San Diego Marine Sediments and Storm Water Quality – the City of San Diego Shipyards Sediment Site Experience <i>Richard Haimann : HDR, Inc.</i>	
9:30 – 10:00	An Innovative, Performance-Based Approach to Stormwater Management: The Lake Clarity Crediting Program <i>Jeremy Sokulsky : Environmental Incentives, LLC</i>		Malibu Creek Bacteria and Nutrient Implementation Plan Addendum <i>Jason Burke : Ventura County Watershed Protection District;</i> <i>Brandon Steets : Geosyntec Consultants</i>	Copermitees, Regulators and Stakeholders: Mock Watershed-Based Planning Process <i>Mikhail Ogawa : Mikhail Ogawa Engineering</i>	
ALTERNATE	Analysis of Storm Water Impacts on Impaired Waters within the Truckee Meadows MS4 Permit Area <i>Jeffrey Curtis : Stantec Consulting Services</i>		Applying a Partitioning Coefficient Analysis to Identify Sources of Metal Pollution in Marina del Rey Harbor <i>Jaime Sayre : Brown and Caldwell</i>	The Sweet Smell of Success: Finding and Eliminating Illicit Connections in Seattle <i>Adam Bailey : Seattle Public Utilities</i>	
10:00- 10:30 BREAK AND EXHIBITOR FOCUS (GRAND SIERRA)					
	TRACK A ALPINE A	TRACK B ALPINE B	TRACK C GRAND SIERRA C	TRACK D MONUMENT PEAK A&B	TRACK E EMIGRANT PEAK A&B
SESSION 5	LAKE TAHOE	TRASH Implementation	REGIONAL / INTEGRATED APPROACHES TO STORMWATER COMPLIANCE	EFFECTIVENESS ASSESSMENT BMPs	CONSTRUCTION PERMIT
MODERATOR	Jason Drew : Nichols Consulting Engineers	Jim Scanlin : Alameda Countywide Clean Water Program	Ruth Kolb : City of San Diego	Michael Drennan : Black and Veatch	Andrew Demers : StormwaterONE.com
10:30 – 11:00	Assessing Lake Tahoe TMDL Baseline Pollutant Load Estimates and Load Reduction Strategies <i>Brent Wolfe : Northwest Hydraulic Consultants</i>	A New Paradigm for a Long-Term Issue – Bay Area Stormwater Trash Load Reduction Framework and Cost-Effective Assessment Strategies <i>Chris Sommers : EQA, Inc.</i>	Stormwater Capture in California: How Far Can It Go? <i>Catherine Tyrrell : RMC Water and Environment</i>	Making Every Bucket Count, Effective Catch Basin Cleaning Strategies <i>Clement Brown : City of San Diego</i>	Tools and Techniques in Permitting for the Water System Improvement Program (WSIP) of the San Francisco Public Utilities Commission (SFPUC) <i>Alan Wong : San Francisco Public Utilities Commission</i>
11:00 – 11:30	Nevada Tahoe Implementing Agencies TMDL Stormwater Load Reduction Plans <i>Karin Staggs : Nevada Tahoe Conservation District</i>	Regional Assessment of Trash in Southern California Streams <i>Ted Von Bither : AMEC</i>	Stormwater Harvesting as an Element of Local Water Supply Development – The Central Basin Municipal Water District Experience <i>Richard Haiman : HDR, Inc.</i>	Rapid Assessment Tools in Tahoe to Verify Effective Water Quality Improvement Actions <i>Nicole Beck : 2NDNATURE LLC</i>	Balancing Cost of Compliance with Appetite for Risk on a Construction Site <i>Tanya Biliezikjian : RBF Consulting</i>

CASQA TECHNICAL PROGRAM AGENDA, WEDNESDAY SEPTEMBER 11, 2013 (cont.)

	TRACK A ALPINE A	TRACK B ALPINE B	TRACK C GRAND SIERRA C	TRACK D MONUMENT PEAK A&B	TRACK E EMIGRANT PEAK A&B
SESSION 5	LAKE TAHOE	TRASH Implementation	REGIONAL / INTEGRATED APPROACHES TO STORMWATER COMPLIANCE	EFFECTIVENESS ASSESSMENT BMPs	CONSTRUCTION PERMIT
MODERATOR	Jason Drew : Nichols Consulting Engineers	Jim Scanlin : Alameda Countywide Clean Water Program	Ruth Kolb : City of San Diego	Michael Drennan : Black and Veatch	Andrew Demers : StormwaterONE.com
11:30 – 12:00	Lake Tahoe Project Alternatives Evaluation: On-the-ground Application of PLRM <i>David Rios :</i> <i>Nichols Consulting Engineers</i>	Oakland's Trash Reduction Effort: Doing More With Less <i>Lesley Estes : City of Oakland</i>	Integration of Modeling Technologies for Stormwater Quality and Integrated Water Resources Planning and Management <i>Mark Hanna :</i> <i>Geosyntec Consultants</i>	Cost Efficient BMP Effectiveness Evaluations at Lake Tahoe, CA <i>Russell Wigart :</i> <i>County of El Dorado</i>	A Case Study of the \$900 Million Dollar Folsom Joint Federal Project, Folsom CA. Storm Water Management of a Multi-Phase, Multi-Contractor, Multi-Permit, Risk Level 3 Project <i>Daniel Holmberg :</i> <i>U.S. Army Corps of Engineers</i>
ALTERNATE	Low Impact Development Guidebook for High Elevations, Placer County <i>Melanie Carr :</i> <i>cbec, inc. eco engineering</i>	Alameda County Reusable Bag Ordinance <i>Meri Soll : Alameda County Waste Management Authority</i>		The Importance of Infiltration BMP Maintenance for Achieving Pollutant Load Reduction Goals in the Tahoe Basin <i>Gary Conely : 2NDNATURE LLC</i>	Meeting Effluent Guidelines in Construction Stormwater Runoff <i>Tim Baulers :</i> <i>Golder Associates Inc.</i>
12:00 –12:15 EXHIBITOR FOCUS AND PRIZE DRAWING (GRAND SIERRA)					
12:15 – 1:30 LUNCH (PAVILION)					
	TRACK A ALPINE A	TRACK B ALPINE B	TRACK C GRAND SIERRA C	TRACK D MONUMENT PEAK A&B	TRACK E EMIGRANT PEAK A&B
SESSION 6	LAKE TAHOE	STORMWATER TREATMENT	REGIONAL / INTEGRATED APPROACHES TO STORMWATER COMPLIANCE	TMDLS AND PROGRAM SPECIFIC COMPLIANCE	CONSTRUCTION PERMIT
MODERATOR	Elisa Garvey : Carollo Engineers	Andrea Crumpacker : Weston Solutions, Inc.	Sara Huber : Weston Solutions, Inc.	Armand Ruby : Armand Ruby Consulting	Lisa Haney : Orange County Sanitation District
1:30 – 2:00	The Caltrans Lake Tahoe Alternative Abrasives Study: Cleaner Sand for Cleaner Runoff <i>Stefan Schuster : CDM Smith</i>	Monitoring the Success of Green Infrastructure in Southern California Urban Retrofits <i>Kristy Morris :</i> <i>Council for Watershed Health</i>	Sustainable Project Planning Using the Institute for Sustainable Infrastructure EnvisionTM Sustainability Rating System Tool <i>Suzanne Wilkins : CDM Smith</i>	How SSOs Can Aid MS4s Comply with Metals TMDLs and Criteria <i>Chris Minton :</i> <i>Larry Walker Associates</i>	Struggles and Lesson's Learned with Determining "Final Stabilization" on USACE Construction Projects <i>John Baum :</i> <i>U.S. Army Corps of Engineers</i>
2:00 – 2:30	How Important is Private Property in Achieving Load Reductions for Water Quality Improvement Projects Associated with the Lake Tahoe TMDL? <i>Kelley Kelso :</i> <i>Nichols Consulting Engineers</i>	Catchment Scale Impacts to Hydrology and Water Quality of Residential Stormwater Street Retrofits in Wilmington, North Carolina <i>Ryan Winston :</i> <i>North Carolina State University</i>	Creating a Sustained Green Infrastructure Retrofit Program – Pipe Dream or Potential Reality? <i>Matt Fabry : San Mateo Countywide Water Pollution Prevention Program</i>	Nutrient and Sediment Accounting for Urban BMPs in the Chesapeake Bay TMDL <i>Thomas Schueler :</i> <i>Chesapeake Stormwater Network</i>	Rainfall in the Forecast? Learn the Difference Between a PoP and a QPF <i>Baxter Vieux :</i> <i>Vieux & Associates, Inc.</i>
2:30 – 3:00	Taylor Creek Snow Park Infiltration BMP's – a Fiscally Sustainable and Regulatory Compliant Strategy at Lake Tahoe, CA <i>Michael Alexander :</i> <i>USDA – US Forest Service</i>	Innovative and Cost Effective Retrofit Design for First Flush Pollutant Treatment at the Ventura County Government Center Parking Lot <i>Jason Burke : Ventura County Watershed Protection District</i>	San Francisco Bay Area IRWMP – Funded Stormwater Projects <i>Jennifer Krebs :</i> <i>San Francisco Estuary Partnership</i>	A Tale of Two Mercury Mines: Lessons Learned Relevant to Any Mercury-Impaired Waterbody <i>Khalil Abusaba : AMEC</i>	Lessons Learned from Linear Underground/Overhead Projects SWPPP Development and Implementation <i>Tania Curulla :</i> <i>Geosyntec Consultants</i>
ALTERNATE	Stormwater, Snowmelt, and Mosquitoes around Lake Tahoe <i>Joel Buettner : Placer Mosquito and Vector Control District</i>	Laguna Beach – Heisler Park ASBS Protection Preservation Project <i>Tracy Ingebrigtsen :</i> <i>City of Laguna Beach</i>		Is Urban Stormwater Ready for Pollutant Trading? – Long Island Sound Pollutant Trading Initiative <i>Richard Haimann : HDR, Inc.</i>	
	Track A – cont. on next page				

	TRACK A ALPINE A
SESSION 6	LAKE TAHOE Extended Session
MODERATOR	Elisa Garvey : Carollo Engineers
3:00 – 3:30	Catchment-Scale Evaluation of FSP Load Predictions by the Pollutant Load Reduction Model (PLRM) <i>Maggie Matbias : 2NDNATURE LLC</i>
3:30 – 4:00	Hybrid BMP Project—Rain Gardens in Incline Village, NV <i>Michael Pook : Nevada Tahoe Conservation District</i>
4:00 – 4:30	Lake Forest Erosion Control Project – The Restoration of Lake Forest Creek <i>Ashley Sanitti : Wood Rodgers</i>

QSD / QSP CONSTRUCTION FORUM

Wednesday, September 11

7:00 a.m. – 8:30 a.m., Alpine Ballroom A

CASQA encourages all QSDs and QSPs to attend. The forum is intended to provide an opportunity to network, discuss lessons learned, hear presentations on topics of current concern, and discuss issues relevant to QSDs and QSPs. The program includes:

- ♦ Introduction & Forum Purpose
Gerald Montgomery : Montgomery & Associates, Inc.
- ♦ Recent Enforcement Update
Melissa Thorne : Downey Brand
- ♦ LUP Lessons Learned
Jennifer Peterson : Nolte Vertical Five
- ♦ Update on Current Statistics and Overview
of New Way for P.E.s and Geologists to Obtain
QSD Status With the SWRCB
Brian Currier :
California State University Sacramento
- ♦ Panel Discussion with *Jeff Endicott : AEI-CASC;*
Jennifer Peterson, Brian Currier and Melissa Thorne

LID ROUNDTABLE

Wednesday, September 11

7:00 a.m. – 8:30 a.m., Alpine Ballroom B

The purpose of the roundtable will be to facilitate a conversation about the following topics:

- ♦ Funding Needs to Build a Robust LID/Green
Infrastructure Program
- ♦ Strategies to Find Funding
- ♦ Barriers to Funding and How to Overcome Them

A summary of the main discussion points will be provided to participants.

- ♦ Chaired by *Scott Taylor : RBF Consulting and*
Jennifer Krebs : State Water Board

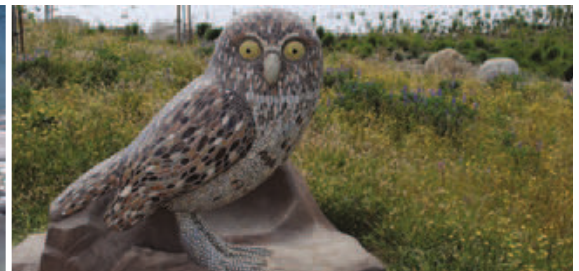

Geosyntec[®]
consultants

geosyntec.com

Providing value-driven and sustainable solutions to
the most challenging stormwater quality problems

Municipal • Industrial
Development • Construction

Huntington Beach • Los Angeles • Oakland • Pasadena • Portland • Riverside • Sacramento • Santa Barbara • San Francisco • San Diego • Seattle

Together, we have the power

to keep the future bright



Edison International is proud to sponsor the
California Stormwater Quality Association *9th Annual Conference.*



LIFE. POWERED BY EDISON.

GOLD STORMWATER STEWARD



Certified Experts and Trainers

Solving Stormwater Compliance Puzzles for Nearly 10 Years

BMP Pilot Studies, Research, Design,
Implementation, Monitoring
Erosion & Sediment Control Management
Hydrology & Hydraulics
Hydromodification Management
Stormwater Compliance & Permitting
Stormwater Management Programs
Stormwater Monitoring, Analysis, &
Reporting
Stormwater Pollution Prevention Plans
(Industrial & Construction)
TMDL Development & Implementation
Training Programs
Watershed Management



URS CORPORATION | 858.812.9292 | www.urs.com

GOLD STORMWATER STEWARD

CASQA CONFERENCE MAP

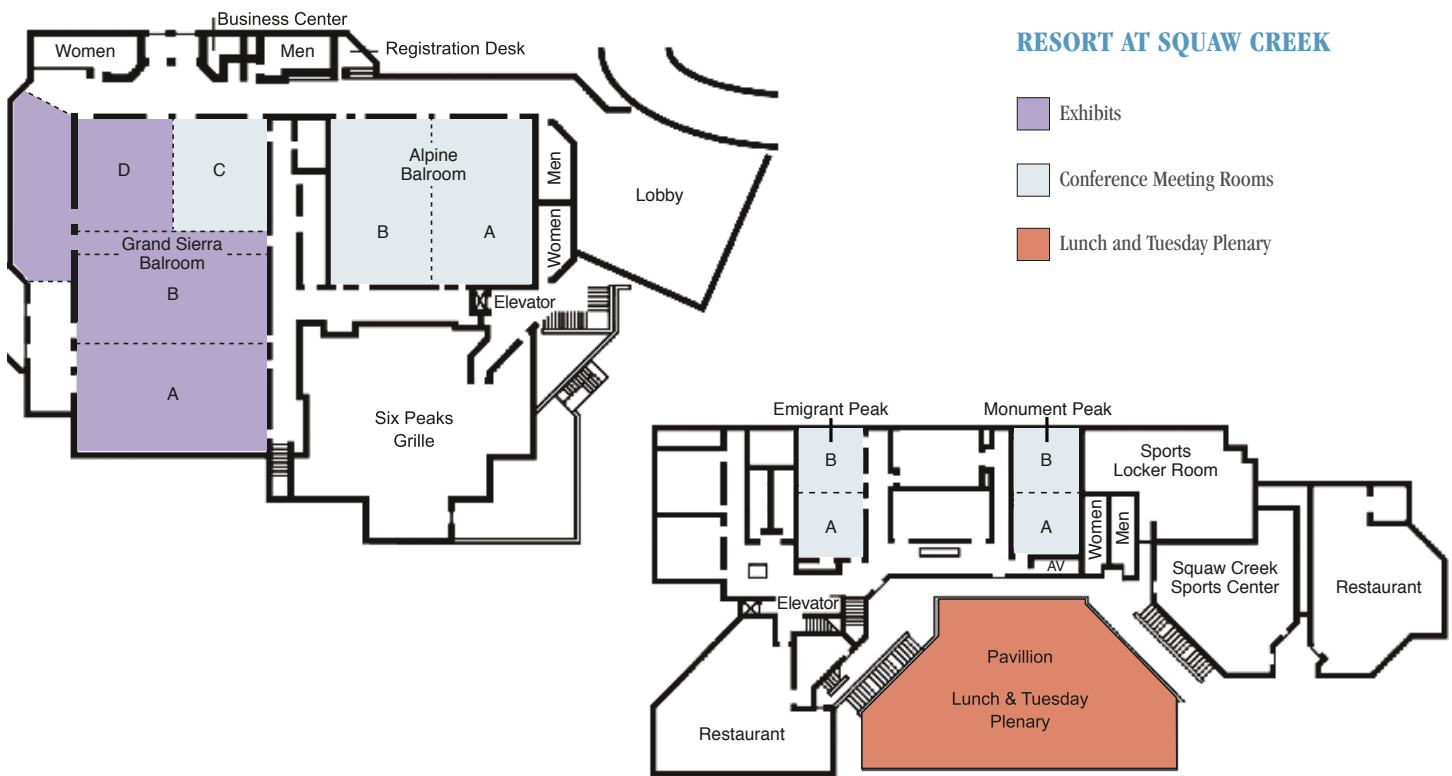

Reduce Runoff from Your Site

CONTECH
ENGINEERED SOLUTIONS

Subsurface Infiltration

Biofiltration & Filtration

Rainwater Harvesting



Achieve your runoff reduction and water quality goals with UrbanGreen stormwater solutions from Contech.

Discover our building block approach at:
www.ContechES.com/urbangreen

URBANGREEN™

www.ContechES.com • 800.338.1122

CASQA CONFERENCE EXHIBITORS AND EXHIBIT HALL MAP

	EXHIBITOR	CONTACT	ADDRESS / PHONE	WEBSITE
1	Inventive Resources, Inc.	John Paoluccio	5038 Salida Blvd., P.O. Box 1316, Salida, CA 95368 Phone (209) 545-1663	www.wdfilters.com
2	StormChamber	Robert Maestro	P.O. Box 672, Occoquan, VA 22125 Phone (703) 492-0686	www.stormchambers.com
3	CBI Systems	Ty Garmon	3120 Fannin Street, Beaumont, TX 77701 Phone (409) 835-3095	www.ms4web.com
4	Hanna Instruments	Josh Ryan	270 George Washington Highway, Smithfield, RI 02917 Phone (800) 426-6287	www.hannainst.com
5	Golder Associates, Inc.	Tim Bauters	425 Lakeside Drive, Sunnyvale, CA 94086 Phone (408) 220-9223	www.golder.com
6	CONTECH Engineered Solutions	Vaikko P. Allen II	2550 Bonmark Drive, Ojai, CA 93023 Phone (310) 850-1736	www.contech-cpi.com
7	Belgard Hardscapes	Gene Weddle	4202 Gibraltar Court, Stockton, CA 95602 Phone (916) 261-8337	www.belgardcommercial.com
8	Filtrexx International	Craig Kolodge	7301 Borla Place, Carlsbad, CA 92009 Phone (760) 429-4041	www.filtrexx.com

EXHIBIT HALL

Grand Sierra Ballroom

- Super Premium Exhibitor
- Premium Exhibitor
- Regular Exhibitor

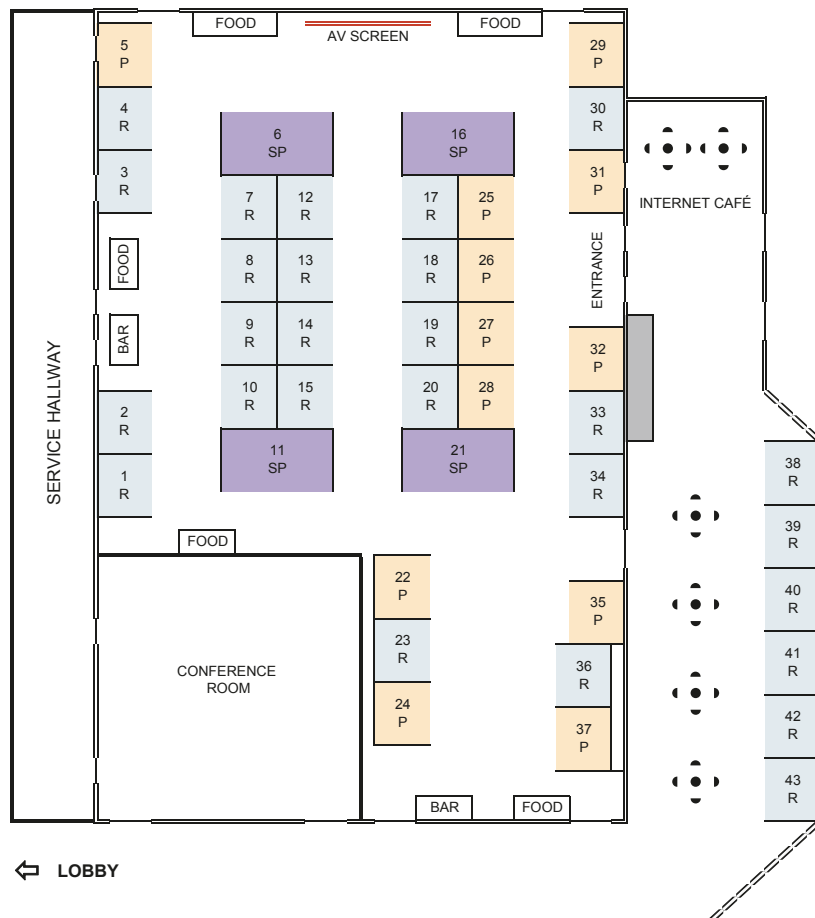

	EXHIBITOR	CONTACT	ADDRESS / PHONE	WEBSITE
9	Tetra Tech	Steve Carter	9444 Balboa Ave., Suite 215, San Diego, CA 92123 Phone (858) 268-5746	www.tetrattech.com
10	United Storm Water, Inc.	Lydia Perry	14000 East Valley Blvd., Industry, CA 91746 Phone (626) 890-7078	www.unitedstormwater.com
11	Downstream Services, Inc.	Kim Carr	2855 Progress Place, Escondido, CA 92029 Phone (760) 746-2544	www.downstreamservices.com
12	Oldcastle Precast	John Scott	7921 Southpark Plaza, Suite 200, Littleton, CO 80120 Phone (888) 965-3227	www.stormcapture.com
13	CUES	Kevin Widmer	630 Eubanks Court, Suite K, Vacaville, CA 95688 Phone (707) 449-1034	www.cuesinc.com
14	Rinker Materials Concrete Pipe Division	Jim Johnston	23200 Temescal Canyon Road, Corona, CA 92883 Phone (909) 322-7604	www.rinkerpipe.com
15	Reed & Graham, Inc.	David Smiley	690 Sunol Street, San Jose, CA 95126 Phone (916) 296-5060	www.rginc.com
16	Bio Clean Environmental/ Modular Wetlands	Janet Kent	2972 San Luis Rey Road, Oceanside, CA 92058 Phone (760) 433-7640	www.BioCleanEnvironmental.com
17	cbec, inc. eco engineering	Melanie Carr	2544 Industrial Blvd., West Sacramento, CA 95691 Phone (916) 231-6052	www.cbecoeng.com
18	XP Solutions	Anthony Kuch	5415 SW Westgate Drive #150, Portland, OR 97221 Phone (888) 554-5022	www.xpsolutions.com
19	JB Water and Wastewater Equipment	Kyle Menath	3386 Tartan Trail, El Dorado Hills, CA 95762 Phone (775) 220-7679	www.JBWater.com
20	complianceGO	Don Reynolds	1700 Bluebird Road, Orem, UT 84097 Phone (801) 701-6188	www.compliancego.com
21	KriStar Enterprises, Inc.	Michelle Dunlop	360 Sutton Place, Santa Rosa, CA 95407 Phone (800) 579-8819	www.kristar.com
22	Stormwater USA, LLC	Andrew Demers	290 Pratt Street #10, Meriden, CT 06450 Phone (877) 257-9777	www.StormwaterONE.com
23	Vieux & Associates, Inc.	Jean Vieux	350 David L Boren Blvd., Suite 2500, Norman, OK 73072 Phone (405) 325-1818	www.vieuxinc.com/getvflo
24	REM Revel Environmental Manufacturing, Inc.	Marcel Sloane	960 B Detroit Ave., Concord, CA 94518 Phone (925) 676-4736	www.remfilters.com
25	Neptune Wheel Wash Systems	Bryan Nichols	174 Cornerstone Court, Suite B, Hot Springs, AK 71913 Phone (501) 525-8484	www.neptunewash.com
26	EarthGuard by Terra Novo, Inc.	Andy Iturriria	2930 Patton Way, Bakersfield, CA 93308 Phone (888) 843-1029	www.EarthGuard.com
27	Shift Business Intelligence, Inc.	Greg McCormick	16523 West Grant Street, Goodyear, AZ 85338 Phone (951) 315-1081	www.shiftstormwater.com
28	C.I. Agent StormWater Solutions	Jamie Aderhold	5142 Bolsa Ave., #105, Huntington Beach, CA 92649 Phone (714) 892-4919	www.ciagent-stormwater.com

CASQA CONFERENCE EXHIBITORS *(cont.)*

	EXHIBITOR	CONTACT	ADDRESS / PHONE	WEBSITE
29	Roscoe Moss Company	Kevin McGillicuddy	4360 Worth Street, Los Angeles, CA 90063 Phone (323) 263-4111	www.roscoemoss.com
30	dat Mobile Solutions	Vishnu Arakere	4744 Baltimore Ave., Hyattsville, MD 20781 Phone (443) 538-5421	www.datmobilesolutions.com
31	American Peat Technology	Ryan Menzel	36203 350th Ave., Aitkin, MN 56431 Phone (877) 257-5906	www.apsorb.com
32	Coanda, Inc.	Cynthia Esmond	3943 Irvine Blvd., #327, Irvine, CA 92602 Phone (714) 389-2113	www.Coanda.com
33	PACE Advanced Water Engineering	Michelle Hoalton	17520 Newhope Street, Suite 200, Fountain Valley, CA 92708 Phone (714) 481-7300	www.pacewater.com
34	Jensen Precast	Marcia Neese	825 Steneri Way, Sparks, NV 89431 Phone (775) 352-2709	www.jensenprecast.com
35	SoundEarth Strategies, Inc.	Mike Chase	3000 Joshua Court, Bakersfield, CA 93301 Phone (866) 850-1900	www.soundearthinc.com
36	SCI Consulting Group	Mary Shilts	4745 Mangels Blvd., Fairfield, CA 94534 Phone (707) 430-4300	www.sci-cg.com
37	Storm Water Systems	Terry Balog	800 East Ocean Blvd., Suite 105, Long Beach, CA 90802 Phone (562) 391-2925	www.stormwatersystems.net
38	NV5	Jennifer Peterson	15070 Avenue of Science, Suite 100, San Diego, CA 92128 Phone (858) 385-0500	www.nv5.com
39	State Water Resources Control Board	Annalisa Kihara	1001 I Street, 15th Floor, Sacramento, CA 95814 Phone (866) 563-3107	www.waterboards.ca.gov
40	Advanced GeoEnvironmental, Inc.	Robert Marty	837 Shaw Road, Stockton, CA 95215 Phone (800) 511-9300	www.advgeoenv.com
41	SWIMS, Inc. Storm Water Inspection & Maintenance Services	Ric Campos	P.O. Box 1627, Discovery Bay, CA 94505 Phone (925) 516-8966	www.swimsclean.com
42	Clearwater Solutions, Inc.	Joe Arthur	P.O. Box 2078, Vista, CA 92083 Phone (951) 315-7777	joe@clearwaterbmp.com
43	AquaShield, Inc.	Eric Rominger	2719 Kanasita Drive, Chattanooga, TN 37343 Phone (423) 870-8888	www.aquashieldinc.com

SUPER PREMIUM EXHIBITORS



www.ModularWetlands.com



Putting nature on its side. Turning an industry on its head.

The only biofilter to utilize **HORIZONTAL FLOW.**
ONE SYSTEM. MULTIPLE TREATMENT STAGES.



DownStream
Services, Inc.

Storm Water and Sanitary Sewer Specialists
www.downstreamservices.com

Please visit Booth #11
at the 9th Annual CASQA Conference
Squaw Valley, Lake Tahoe
September 9-11, 2013





Dominguez Gap Wetlands, Long Beach, CA

Creating Innovative and Sustainable Stormwater Solutions for Our Clients

With more than ten offices in California, our engineers, scientists, and planners work collaboratively to address the needs of our clients including:

- Sustainable Development
- Stormwater Quality
- TMDL Studies / Implementation
- LID Studies / Design
- BMP Design

CH2MHILL.com

© 2010 CH2M HILL
WBG091410193406SCO



cleanwater
PROGRAM
alameda county

Protecting **Alameda County**
Creeks, Wetlands & the Bay

cleanwaterprogram.org

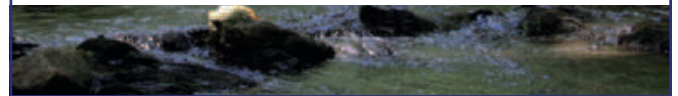

SUSTAINABLE

INNOVATIVE

COMMITTED



www.WRECO.com

INFO@WRECO.COM

(925) 941-0017

WATER RESOURCES | CIVIL ENGINEERING | ENVIRONMENTAL COMPLIANCE | GEOTECHNICAL ENGINEERING

Greater Program Impact Through Better Environmental Chemistry

Lower-Detection Higher-Performance Standard Production Function

Foreseen, Advanced, Targeted, Required Analyses

Integrative-Informed Consulting Support

Decision-Making Data

Robust Reporting

PHYSIS

TERRA FAUNA FLORA AQUA AURA
ENVIRONMENTAL LABORATORIES, INC.

Innovative Solutions for Nature

Anaheim, California

Municipal Regional Coastal Global

Regulatory Research Consulting Cooperative Communities

info@physislabs.com

Protect it. Deliver it. Solve it.

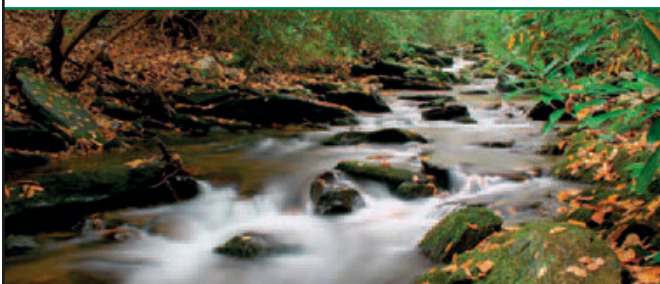

**Water Quality.
Strategic Solutions.
Discharge Permitting.**

At the forefront of proceedings related to Section 303(d) waterbody impairment listings, TMDLs, Basin Plan Amendments, NPDES Permit actions, Section 401 certifications, CEQA, and general surface and stormwater related water quality issues under the federal Clean Water Act and the State Porter-Cologne Water Quality Control Act.

No matter your need—Nossaman *makes it happen.*

 **NOSSAMAN** LLP
nossaman.com/water

DOWNEY | BRAND

ATTORNEYS LLP

Advancing your interests.

**Municipal, Industrial & Construction
Storm Water Expertise**

**Permit Negotiation & Regulatory
Enforcement**

**Compliance Counseling
Litigation Defense**

Contacts:

**Nicole Granquist • Melissa Thorme
Katharine Wagner**

916/444-1000

downeybrand.com



hydrology | hydraulics | geomorphology | design | field services

sustainable stormwater management
environmental rehabilitation
multi-objective flood management
climate change analytical services

www.cbecoeng.com

great minds think eco-like

LARRY WALKER ASSOCIATES



ASSOCIATES

Science. Policy.
Solutions.

Environmental engineering and consulting.
 Providing innovative water quality solutions throughout California for over 30 years.

Home Office
Davis, CA | 530.753.6400
 with regional offices
 in Oakland, Santa Monica,
 San Jose and Ventura

www.lwa.com

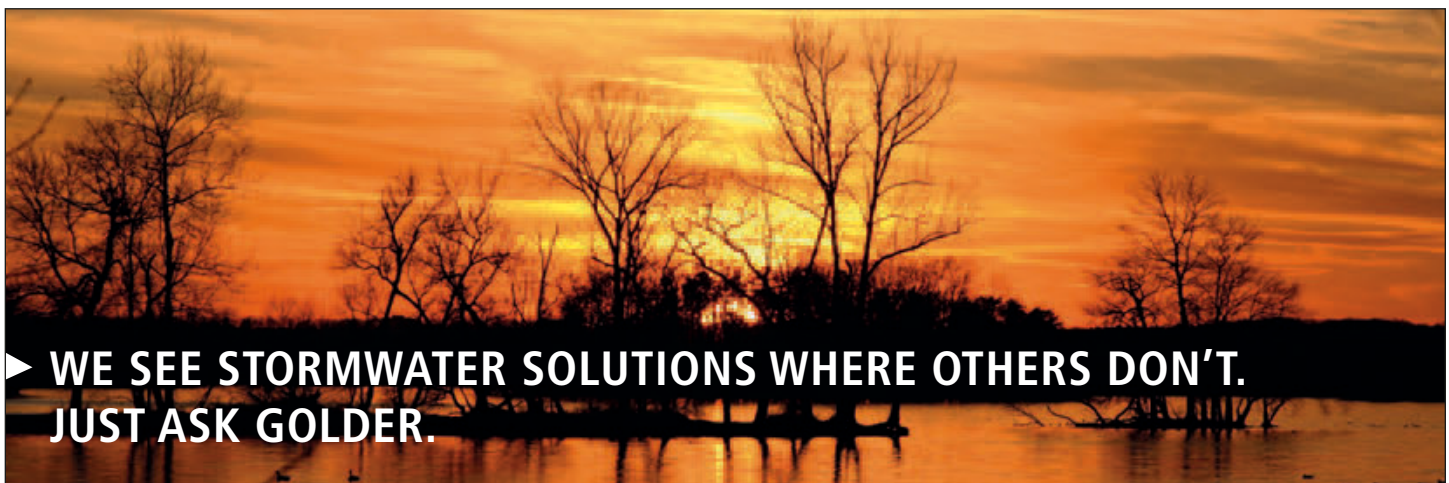

► **WE SEE STORMWATER SOLUTIONS WHERE OTHERS DON'T.
JUST ASK GOLDER.**

Golder's California stormwater specialists have expertise in all phases of stormwater management and compliance. We draw on our experience to apply effective solutions during permitting and routine BMP maintenance and inspection services, and through development of BMP recommendations and treatment options. Golder achieves results that meet our clients' needs.

Engineering Earth's Development, Preserving Earth's Integrity.

Golder Associates' California Offices:

Irvine

(714) 508-4400

Tony Augello, PhD, PE

Sacramento

(916) 786-2424

Ed Childers, PE

Sunnyvale

(408) 220-9223

Tim Bauters, PhD, PE

Walnut Creek

(925) 956-4800

Ken Chin, PE

solutions@golder.com

www.golder.com





**STORM WATER
SYSTEMS**

Cleaning our water one system at a time.

The only cost effective **SYSTEM** that **GUARANTEES BENCHMARKS**

Visit us at **Booth 37**



Turnkey storm water solutions.

Proven data and numerous systems installed.

Enhanced Media Treatment and **Mechanical Separation Technology.**

We can affordably upgrade and maintain your existing **Treatment System** to meet **Benchmarks.**

Team of **legal advisors** with **over 50 years of combined experience** to assist you with a **clear path to compliance.**

www.StormWaterSystems.net

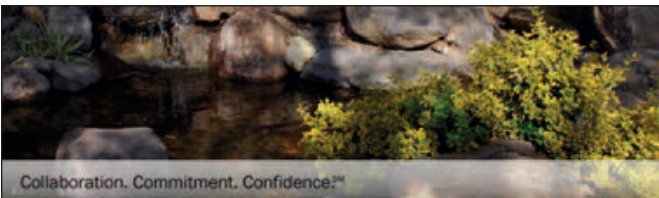

Collaboration. Commitment. Confidence.™



NICHOLS CONSULTING ENGINEERS
Engineering and Environmental Services

Follow Us 

- Stormwater Program Management
- NPDES Permit Compliance
- Stormwater Infrastructure Design
- Stormwater Monitoring
- QSD/QSP Services



Lake Tahoe ■ Sacramento ■ Bay Area ■ Orange County ■ Reno



NCE is a multi-disciplinary engineering, science, planning and construction services firm who works collaboratively with our clients throughout California and Nevada. With the ability to integrate diverse disciplines our clients can be confident in the technically sound services NCE delivers.

For more information, visit www.ncenet.com

REED & GRAHAM
GEOSYNTHETICS

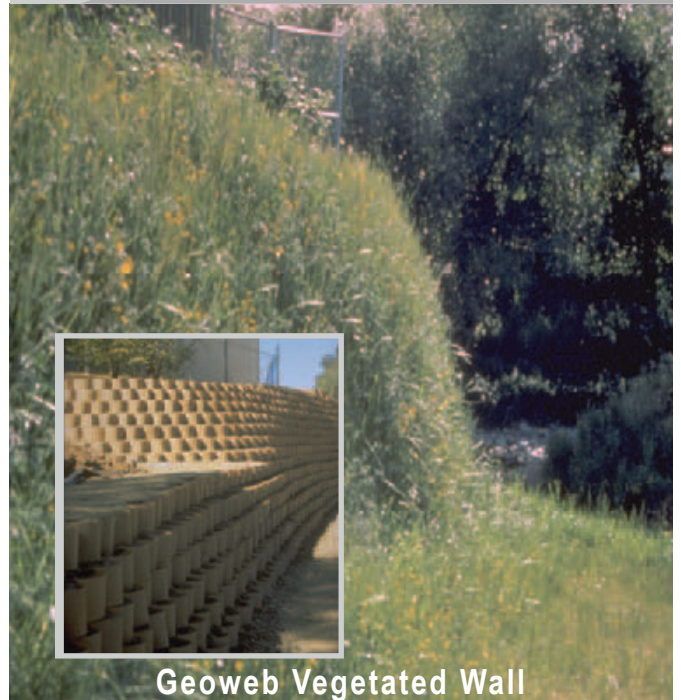

Geoweb Vegetated Wall



REED & GRAHAM
GEOSYNTHETICS

(888) 381-0800
www.rginc.com



Environmental and Planning Consultants



Watershed Management
Water Quality Monitoring and Assessment
TMDL Implementation
Restoration Design
Sediment Transport Modeling and Management
NPDES Permit Compliance
Hydromodification Planning and Compliance
Master Plans
LID Planning and Design

Los Angeles
Oakland
Palm Springs
Petaluma
Sacramento
San Diego
San Francisco
Santa Cruz
Woodland Hills
www.esaassociates.com

aquatic
bioassay &
consulting
laboratories, inc



'quality marine & freshwater biological services since 1988'

- ◆ Aquatic & Sediment Toxicology
- ◆ Watershed Assessments
- ◆ Coastal & Harbor Marine Sciences
- ◆ Taxonomic Services



aquatic bioassay & consulting laboratories, inc
29 north olive ventura, ca 93001 (805) 643 5621



Slope Stabilization



Underground Rain Harvesting Tanks

Thunder Mountain Enterprises, Inc.

WWW.TME1.COM • 916-381-3400

SWPPP Design & Consulting • Erosion & Sediment Control • Slope Stabilization

Pond & Basin Liners • Land & Stream Restoration • Wetland Construction • Dust Control • Rain Water Harvesting

APT²sorb

Sorption Media for Dissolved Heavy Metals

Treatment for:

Stormwater
Process Water
Industrial Sites
Mine Sites

Versatile Deployment

Low Maintenance

Landfill Disposal

Effective on
Cu, Ni, Pb, Cd
Cr, Zn, Al, Mn

Call 218.927.1888

www.AmericanPeatTech.com



MARK YOUR CALENDARS

10TH ANNUAL CASQA CONFERENCE

SEPTEMBER 15–17, 2014

HYATT REGENCY ORANGE COUNTY

CALIFORNIA



California Stormwater Quality Association

P.O. Box 2105, Menlo Park, California 94026-2105

Phone (650) 366-1042 www.casqa.org

CASQA CONFERENCE SUBCOMMITTEE

CASQA would like to thank the Conference Subcommittee members for coordinating this year's conference.

Conference Co-Chairs

Lisa Austin and Sharon Gosselin

A/V Coordinator

Jamie Aderhold and Jason Lawrence / Advanced Media

Awards Coordinator

Gerhardt Hubner

CEU Coordinator

Daniel Apt

Exhibitor Coordinator

Karen Ashby

Graphic Design

Bev Catli Manzano / Beverly Catli Design

Meals Coordinator

Kristina Schneider

Moderator Coordinator

Lisa Haney

Overall Program Coordinators

Bill Flores and Kevin McGillicuddy

Program Track Leads

Lisa Austin, Richard Boon, Michael Drennan, Jason Drew, Elisa Garvey, Stephen Groner, Lisa Haney, Jon Konnan, Anna Lantin, Tom Lawrence, Matt Lentz, Sandy Mathews, Kelly Moran, Jim Scanlin, Kristina Schneider, Ashmita Sengupta, Scott Taylor and Chandra Thomas

Overall Workshop Coordinator

Nancy Gardiner

Workshop Leads

Daniel Apt, Carmel Brown, Jeff Endicott, Nancy Gardiner, Judd Goodman, Steve Groner, Andre Monette, Dave Renfrew, Bram Sercu and Brandon Steets

Promotions Coordinator

Chris Crompton

Social Event Coordinators

Joy Guinn, Nicole West, Elisa Garvey, Ashmita Sengupta and Lisa Skutecki

Sponsorship Coordinators

Matt Lentz, Tanya Bilezikjian and Lisa Skutecki

Website Coordinator

Stephanie Reyna-Hiestand

Conference Coordinator

April Krieg

Members-at-Large

Gene Estrada, Jill Bicknell, Tom Lawrence, Jason Uhley and Richard Watson

CASQA Event Coordinator

Amy Porter

CASQA Executive Assistant

Shelley Larson

CASQA Web Designer

Adam Humphrey

CASQA Executive Director

Geoff Brosseau

CASQA Treasurer

Sharon Gosselin

CASQA Chair

Richard Boon